

ROHS

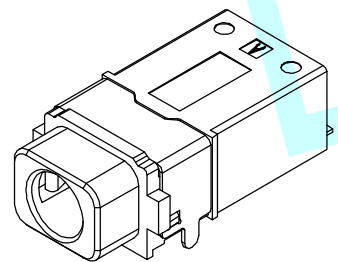

SCHEMATIC (PLUG OUT)

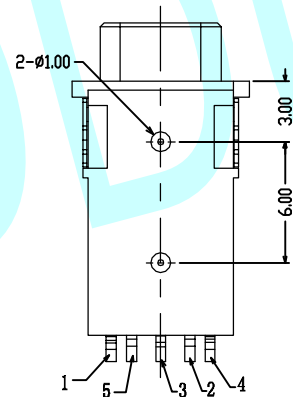
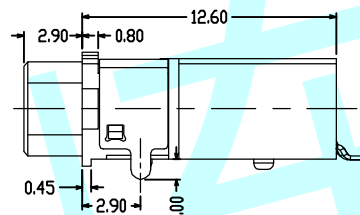
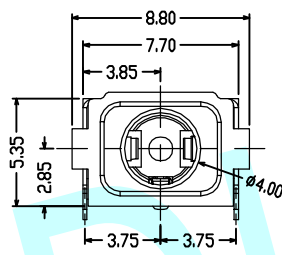
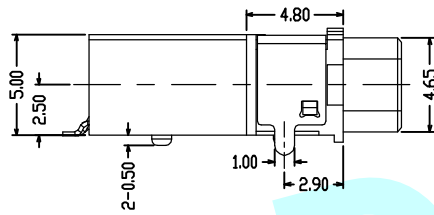
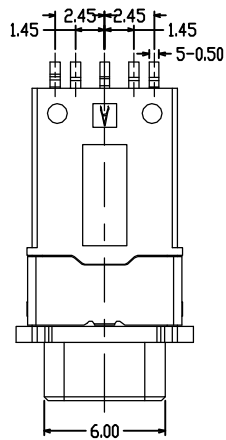
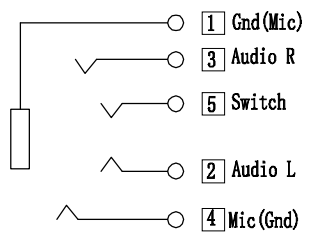

SCHEMATIC (PLUG IN)

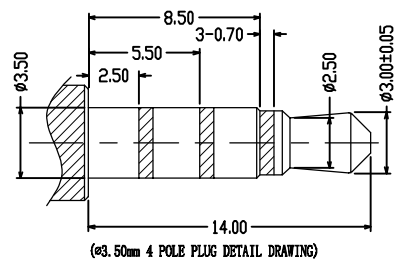
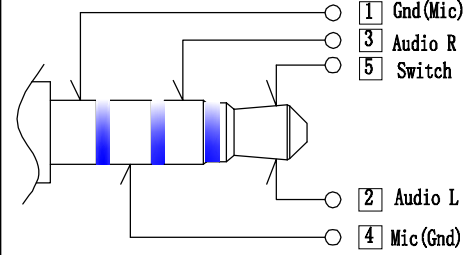

SPECIFICATION:

1. CURRENT RATING:DC 0.5A MAX
- 2.VOLTAGE RATING:DC 12V
- 3.CONTACT RESISTANCE:50mΩ MAX.
4. INSULATION RESISTANCE:100MΩ MIN. AT 500V DC
5. WITHSTANDING VOLTAGE:500V AC FOR 1 MINUTE
- 6.LIFE TEST:5000 CYCLES MIN
7. MATING FORCE:3~30N,
UNMATING FORCE:3~30N.
8. TEPROOF LEVEL: IPX7

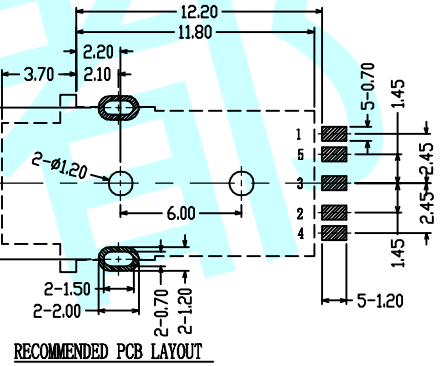

ITEM	NAME	Q'TY	DESCRIPTION
8	COVER	1	HIGH TEMPERATURE PLASTIC COLOR BLACK
7	HOUSING	1	HIGH TEMPERATURE PLASTIC COLOR BLACK
6	SHELL	1	PHOSPHOR BRONZE; NICKEL PLATED OVERALL
5	TERMINAL 5#	1	
4	TERMINAL 4#	1	PHOSPHOR BRONZE; GOLD FLASH ON CONTACT AREA;
3	TERMINAL 3#	1	GOLD FLASH PLATING ON SOLDER TAIL AREA, ALL OVER NICKEL PLATED
2	TERMINAL 2#	1	PHOSPHOR BRONZE; GOLD FLASH ON CONTACT AREA;
1	TERMINAL 1#	1	GOLD FLASH PLATING ON SOLDER TAIL AREA, ALL OVER NICKEL PLATED

APPROVALS		DATE	http://www.dongdudz.com		 东都电子 DONGDU ELECTRONICS
DRAW:	ZRD	2017-12-6	TOLERANCE:	ANGLE:	
CHECKED:	***	****	30≥	±0.30	
APPOVALS:	***	****	10°30	±0.20	
			5°10	±0.15	
≤5	±0.10	±2°	MODEL:	PHONE JACKES	
			PART NO:	PJ-881	
			UNIT :mm	SCALE:1:1	UNIT: mm
			REV:	A	PAGE:1/1